

Newer Heights **VILLAGE**

STARTING IN THE MID \$500's
3 BEDROOMS | 3.5 BATHROOMS | 2,467 SQFT



MARKETED BY

CitiQuest
PROPERTIES

Newer Heights Village

DESCRIPTION

Recently completed patio home in the Heights by an established Memorial/Heights builder with first-floor living and modern design. This 2,467 SF home offers 3 bedrooms, 2.5 baths, and an open-concept layout. The kitchen features stylish countertops, white cabinetry, stainless steel appliances, and designer finishes. The main living area flows into a dining space with access to a private backyard. All bedrooms are located on the second floor, including a primary suite with tray ceilings, private balcony, soaking tub, dual vanities, and separate glass shower. Two secondary bedrooms and utility room also on second floor. Third floor includes a versatile game room with half bath, ideal for a second living area or office. Private backyard, two-car garage, and gated community with private streets. Virtual tour available—contact agent for incentives. Virtual tour available. Contact agent for current incentives.

FEATURES

- Recently completed patio home by an established Memorial/Heights builder
- First-floor living with a modern, open-concept design
- Stylish kitchen with white cabinetry, stainless steel appliances, and designer finishes
- Spacious primary suite with private balcony, soaking tub, dual vanities, and glass shower
- All bedrooms plus utility room conveniently located on the second floor
- Third-floor game room with half bath—perfect for a second living space or office
- Private backyard, two-car garage, and gated community with private streets



Floorplans

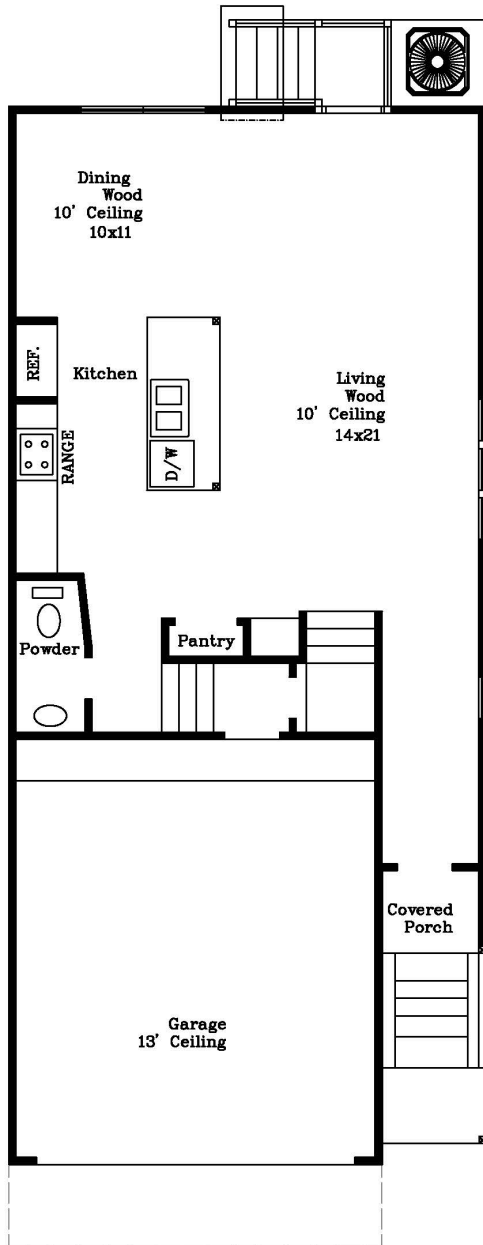

FIRST FLOOR

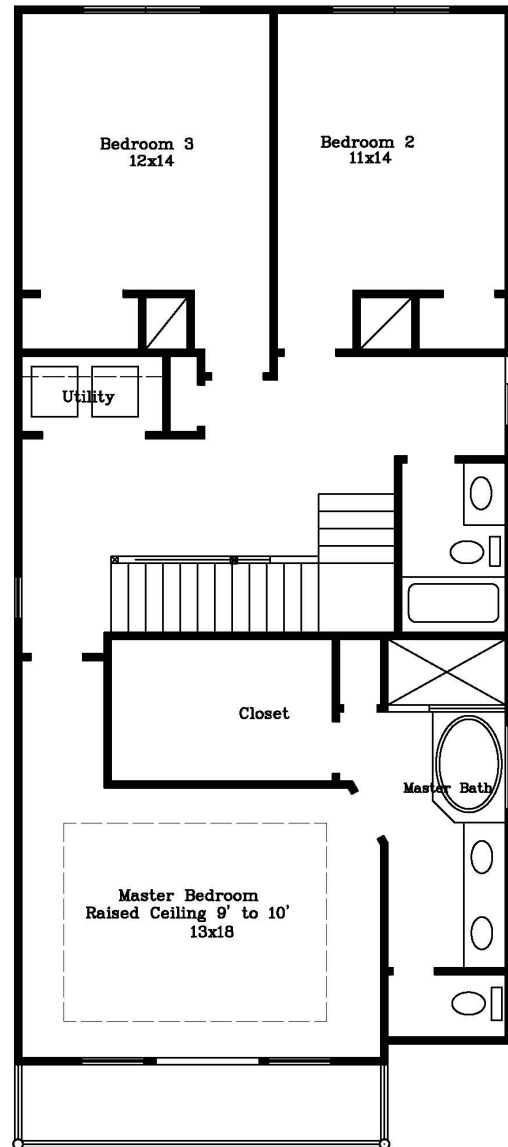

SECOND FLOOR

Siteplan & Availability

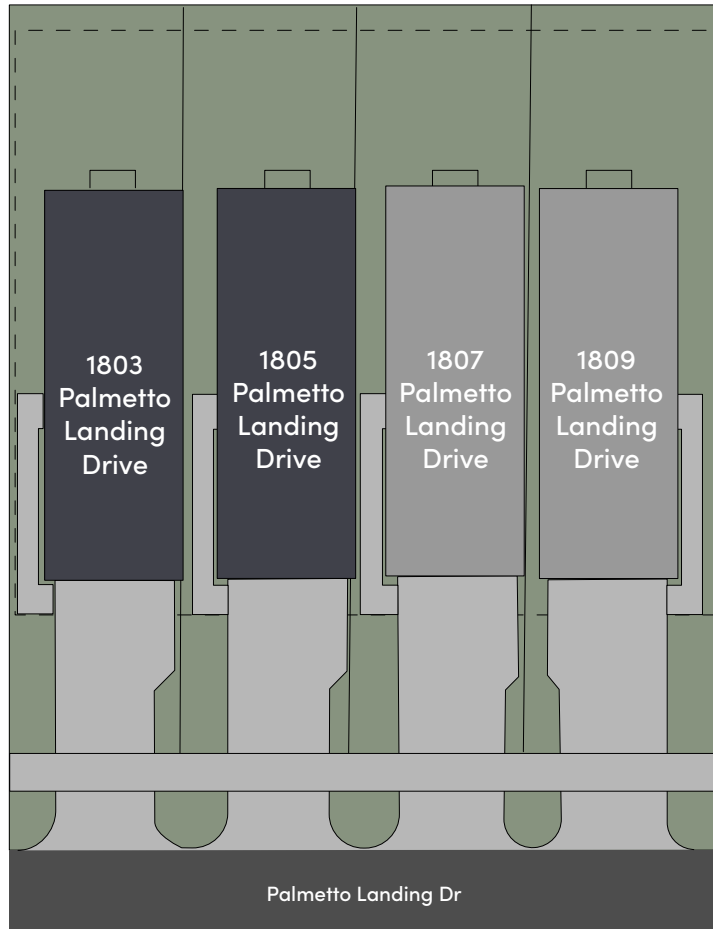

Address	Sqft	Beds	Baths	Pricing
1805 Palmetto Landing Dr	2,467	3	3.5	\$524,900
1805 Palmetto Landing Dr	2,467	3	3.5	\$524,900

MARKETED BY

CitiQuest
PROPERTIES

www.citiquestproperties.com



SCAN FOR MORE
INFORMATION

Patrick Burbridge
713.581.6000
sales@cqhouston.com